

PLUG1

Gas Outlet

Thank you for purchasing the **PLUG1** Gas Outlet:

The PLUG1 gas outlet makes it easy to move, store or switch outdoor appliances. Insert the gas plug fully into the new PLUG1 gas outlet. Push the switch to the “ON” position. The appliance is now connected to the gas supply.



What To Do If You Smell Gas:

- Do not try to light any appliance.
- Do not touch any electric switch; do not use any phone in the area.
- Immediately call your gas supplier from a neighbor's phone.
Follow the gas supplier's instructions.
- If you cannot reach your gas supplier, call the fire department.

General Notes:

- Do not subject PLUG1 gas outlet to open fire or excessive heat. PLUG1 is designed to operate at a max. ambient temperature of 200°F (93°C).
- Do not expose PLUG1 to solvents, oil, dirt, grease or other chemical agents.
- Do not paint PLUG1 cover plate or any of its components. The cover plate may be cleaned with a damp cloth and a mild dish washing liquid.
- Do not subject PLUG1 to mechanical stress. Proper usage requires no excessive force.
- For performance reasons, it is highly recommended that the gas plug supplied be used with the PLUG1 gas outlet.

▲ WARNING

If these instructions are not followed exactly, a fire or explosion may result causing property damage, personal injury or death.

▲ WARNING

No attempt shall be made to convert the gas appliance from the gas specified on the rating plate for use with a different gas without consulting the installation instruction, the serving gas supplier, or the equipment manufacturer for complete instructions.

Installation Requirements:

Installation of the PLUG1 gas outlet must be performed by a qualified installer or the gas supplier. There are no serviceable parts inside. Do NOT open.

PLUG1 shall be installed in accordance with local codes or, in the absence of local codes the National Fuel Gas Code, ANSI Z223.1/NFPA 54 National Gas and Propane Installation Code, CSA B149.1 as is applicable, and operated in accordance with manufacturer's instructions. Installation, inspection and replacement must be performed by a qualified installer or the gas supplier.

The gas plug must be connected to an approved flexible appliance connector according to ANSI Z21.54/CSA 8.4 (outdoors) or Z21.69/CSA 6.16, Z21.24/CSA 6.10 (indoors).

Suitable for use with natural, manufactured, mixed and propane (LP) gases and LP gas-air mixtures.

PLUG1 Product Features:

The PLUG1 is a gas outlet and much more. The PLUG1 has an integrated excess flow valve that shuts off the gas flow when a predefined flow rate occurs (figures A & B). In addition, an integrated high temperature activated shut-off device shuts off the gas flow when a predefined temperature occurs.

- For indoor or outdoor use
- Suitable for use with natural, manufactured, mixed and propane (LP) gases and LP gas-air mixtures.
- Integrated excess flow valve
- Manual ON/OFF gas switch function
- Pipe material: CSST, semi-rigid copper tubing, black iron pipe
- Mounting position: Gas inlet is located on the top of the PLUG1
- CSA certified
- Integrated high temperature activated shut-off device activates before temperature reaches 300°F (149°C).
- Ambient temperature range: -20°F to 200°F (-29°C to 93°C)
- Maximum pressure rating: 5 psi (345 mbar)
- Gas supply inlet connection: 1/2" NPT
- Gas outlet connection: 3/8" NPT
- Maximum nominal capacity of appliance: 70,000 BTU/hr (20.5 kW)
- Gas plug cannot be disconnected from PLUG1 when switch is in the "ON" position.

Limited Warranty:

Disclaimers, Exclusive Remedy, and Limitation On Liability - Maxitrol warrants that its product is manufactured free from defects in materials and workmanship under normal use and specifications, and will operate as such for a period of one (1) year from the date of manufacture. This limited warranty extends only to the original purchaser. Damage and/or injury due to or resulting from its shipment, and/or use not in accordance with specifications including, but not limited to, faulty installation, adjustments, exposure to excessive pressure, temperature, debris, moisture and/or corrosive chemicals, improper application, misuse or abuse, non-specified product or part modification or the negligence of others are not covered by the warranty and are not the responsibility of Maxitrol. There are no other warranties expressed or implied.

Integrated Excess Flow Valve:

Excess Flow Valve in normal/OPEN position.
(Shaded area represents gas flow.)

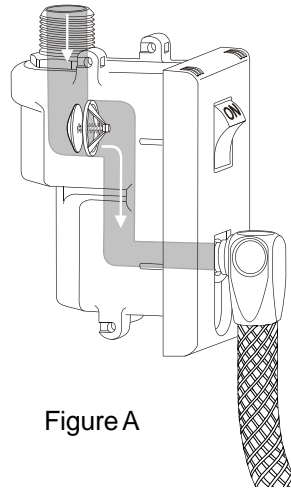

Figure A

Excess Flow Valve in CLOSED position.
Gas supply is shut off.
(Shaded area represents gas flow.)

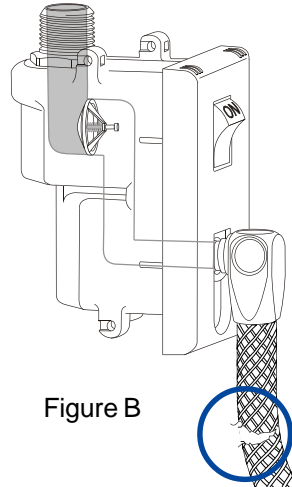
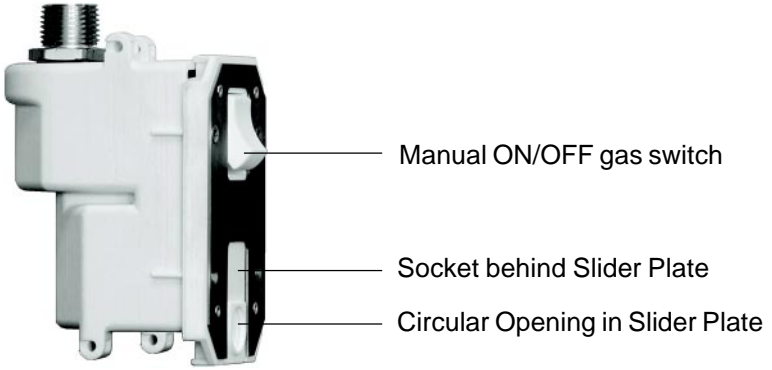

Figure B

NOTE: Excess Flow Valve automatically reopens after repair has been made and gas plug is reinserted into Plug1 gas outlet.

Components:



PLUG1 Gas Outlet



Snap-On Cover Plate



Gas Plug
(hose not included)

Connecting a gas appliance to the **PLUG1** Gas Outlet:

NOTE: Without the gas plug inserted into the outlet, no gas will flow regardless of the position of the ON/OFF switch. With the switch in the “ON” position it is not possible to connect the gas plug.

Step 1: The ON/OFF gas switch must be in the “OFF” position to insert the gas plug. (“ON” label on switch will not be visible.)

Step 2: Insert gas plug into the slider’s circular opening.

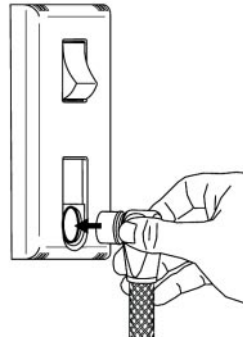

Step 3: Move the slider plate upwards.

Step 4: Push the gas plug fully into the socket opening.

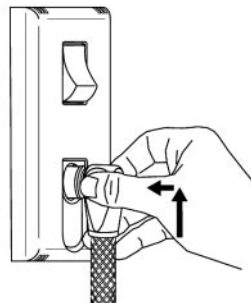

- Step 5:** To turn on gas, push the switch to the “ON” position (“ON” will be visible on top of switch).
The appliance is now connected to the gas supply.

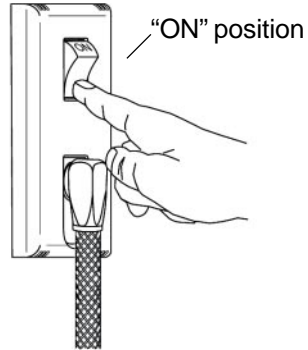

Disconnecting a gas appliance from the **PLUG1** Gas Outlet:

- Step 1:** 1. Push switch to the “OFF” position.
2. Pull gas plug straight out of socket.
The appliance is now disconnected from the gas supply.

